

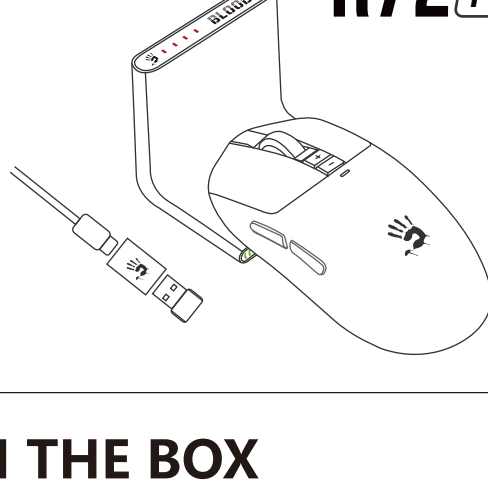

R72 Pro Duo

QUICK START GUIDE



WHAT'S IN THE BOX

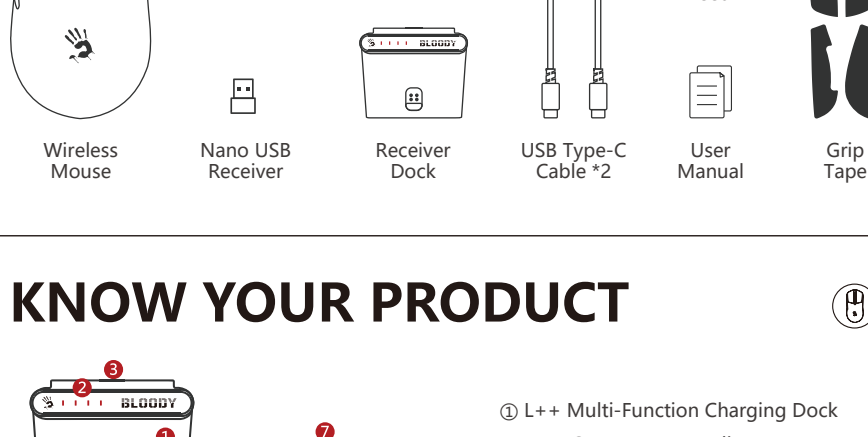

KNOW YOUR PRODUCT

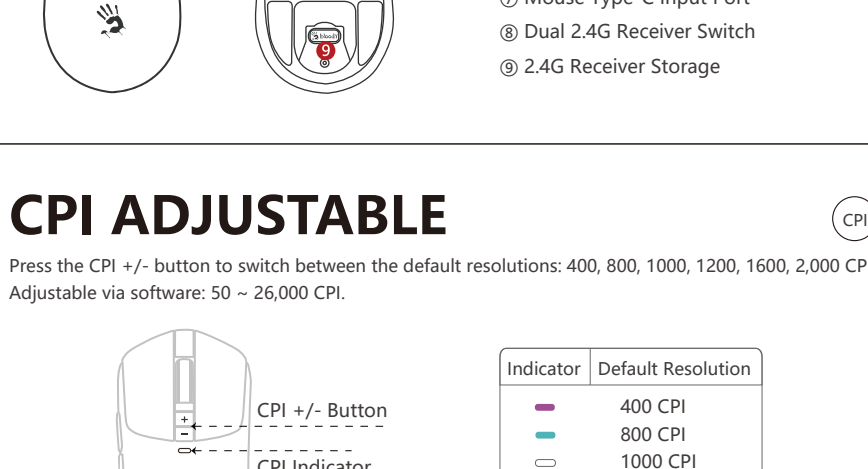

- ① L++ Multi-Function Charging Dock
- ② Four-Stage Battery Indicator
- ③ Dock Type-C Input Port
- ④ CPI +/- Adjustable
- ⑤ Function Indicator
- ⑥ Snap-On Magnetic Charging
- ⑦ Mouse Type-C Input Port
- ⑧ Dual 2.4G Receiver Switch
- ⑨ 2.4G Receiver Storage

CPI ADJUSTABLE

Press the CPI +/- button to switch between the default resolutions: 400, 800, 1000, 1200, 1600, 2,000 CPI. Adjustable via software: 50 ~ 26,000 CPI.

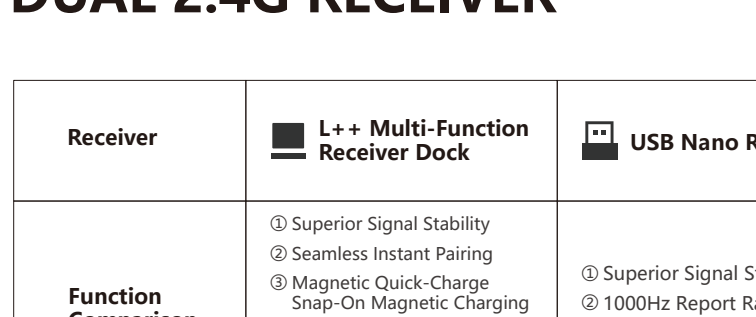

Indicator	Default Resolution
	400 CPI
	800 CPI
	1000 CPI
	1200 CPI
	1600 CPI
	2000 CPI

*If the CPI button is not clicked for 15s, the indicator will turn off automatically.

DUAL 2.4G RECEIVER

Receiver	L++ Multi-Function Receiver Dock	USB Nano Receiver
Function Comparison	<ul style="list-style-type: none"> ① Superior Signal Stability ② Seamless Instant Pairing ③ Magnetic Quick-Charge Snap-On Magnetic Charging ④ Four-Stage Battery Indicator ⑤ 1000Hz Report Rate ⑥ Desktop Use 	<ul style="list-style-type: none"> ① Superior Signal Stability ② 1000Hz Report Rate ③ Travel Portable

DUAL 2.4G RECEIVER SWITCH

If both receivers are connected, you can choose the active one using the switch on the bottom of the mouse.

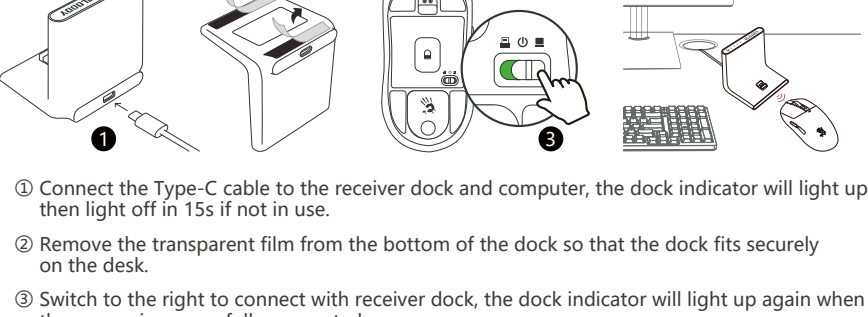

- Nano Receiver ----- Switch Left
- Receiver Dock ----- Switch Right
- Power Off ----- Middle

- ① Press to pop up the lid.
- ② Take out the Nano Receiver and put the lid back.

CONNECT RECEIVER DOCK

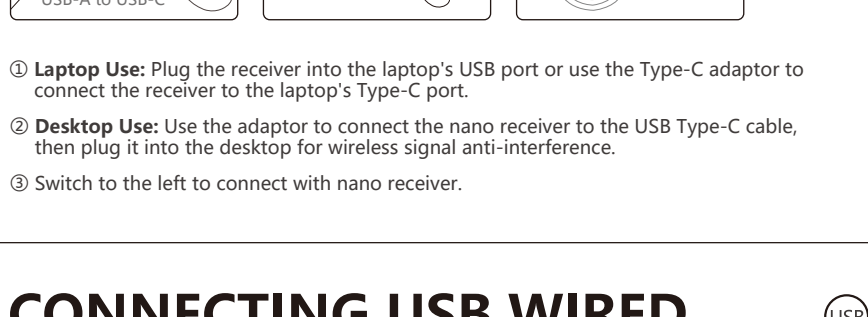

- ① Connect the Type-C cable to the receiver dock and computer, the dock indicator will light up then light off in 15s if not in use.
- ② Remove the transparent film from the bottom of the dock so that the dock fits securely on the desk.
- ③ Switch to the right to connect with receiver dock, the dock indicator will light up again when the mouse is successfully connected.

CONNECT 2.4G NANO RECEIVER

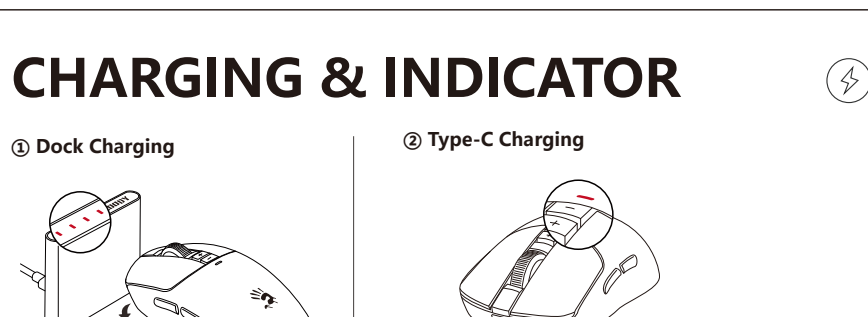

- ① **Laptop Use:** Plug the receiver into the laptop's USB port or use the Type-C adaptor to connect the receiver to the laptop's Type-C port.
- ② **Desktop Use:** Use the adaptor to connect the nano receiver to the USB Type-C cable, then plug it into the desktop for wireless signal anti-interference.
- ③ Switch to the left to connect with nano receiver.

CONNECTING USB WIRED

The mouse will switch from wireless to wired mode when the USB Type-C cable is connected. **Note:** While in wired mode, the mouse charges simultaneously.



Connect to the Desktop Computer

Connect to the Laptop Computer

CHARGING & INDICATOR

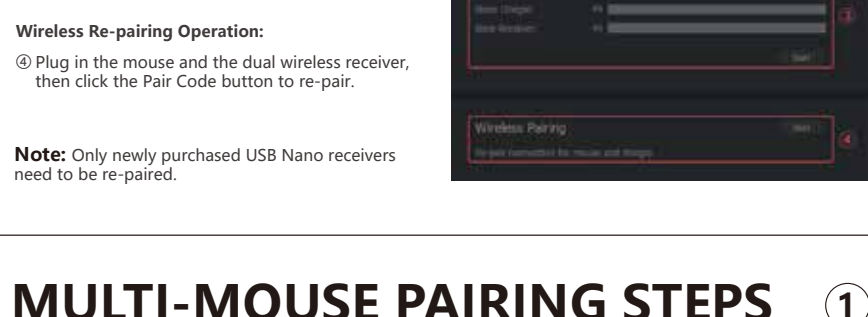

Dock Indicator (Battery Level)

- 25%
- 50%
- 75%
- 100%

Mouse Indicator

- Solid Red -- Charging
- Solid Green -- Fully Charged
- No Light: Working
- Flashes Red: Below 15% Battery

WIRELESS M-ESPORT EDITOR

Optimize your mouse settings with simple combinations and programming functions. Customize buttons, sensitivity, and macros, then save them to the mouse's on-board memory.

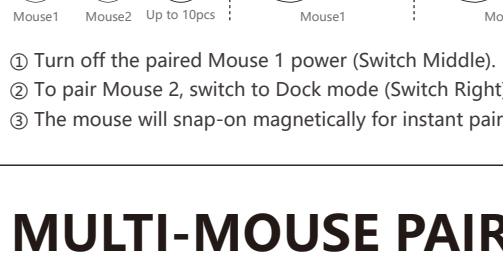

Download Link: <http://www.bloody.com/en/download.php>

FIRMWARE UPDATE OPERATION

Ensure the USB connection is not interrupted during the update process.

- ① Plug both the mouse and dongle into the USB port.
- ② Confirm that the mouse and dual receivers are online simultaneously.
- ③ When prompted to upgrade the firmware, click the Upgrade button to complete the process.

Wireless Re-pairing Operation:
④ Plug in the mouse and the dual wireless receiver, then click the Pair Code button to re-pair.

Note: Only newly purchased USB Nano receivers need to be re-paired.

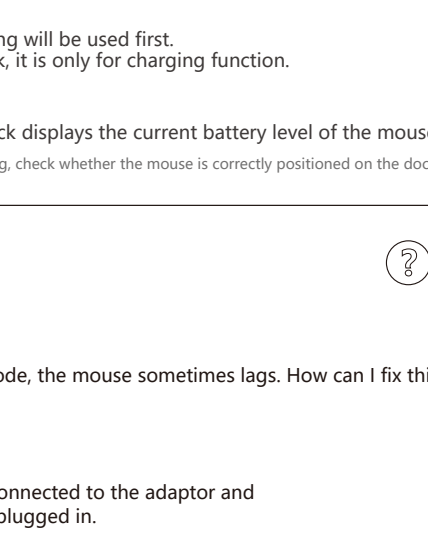

MULTI-MOUSE PAIRING STEPS ①

When using the L++ multi-function dock, it can pair with multiple wireless mice that support dual-connected wireless systems. Here's how to perform random pairing.

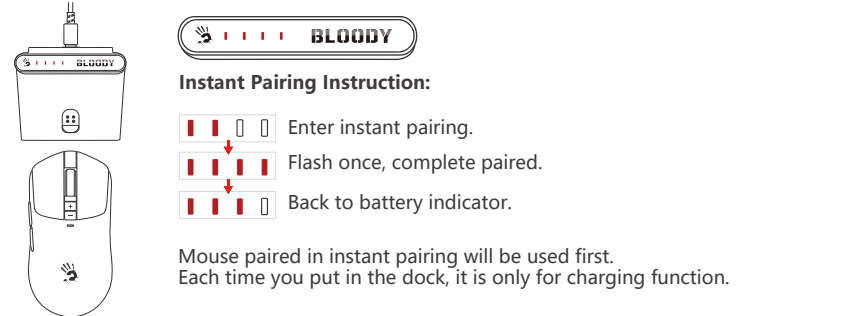

- ① Turn off the paired Mouse 1 power (Switch Middle).
- ② To pair Mouse 2, switch to Dock mode (Switch Right).
- ③ The mouse will snap-on magnetically for instant pairing.

MULTI-MOUSE PAIRING STEPS ②

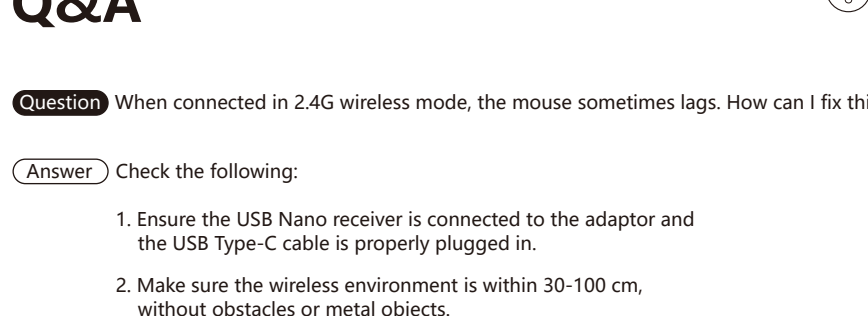

Mouse paired in instant pairing will be used first. Each time you put in the dock, it is only for charging function.

④ Pairing completes in 1s. After pairing, the dock displays the current battery level of the mouse.

* Note: If the charging dock lights keep flashing during pairing, check whether the mouse is correctly positioned on the dock.

Q&A

Question When connected in 2.4G wireless mode, the mouse sometimes lags. How can I fix this?

Answer Check the following:
1. Ensure the USB Nano receiver is connected to the adaptor and the USB Type-C cable is properly plugged in.
2. Make sure the wireless environment is within 30-100 cm, without obstacles or metal objects.
3. Ensure there are no strong wireless routers or other interference sources within 1 meter.

Q&A

Question Wireless 1000Hz transmission is smooth like wired. Can I achieve the same with 500Hz?

Answer 1000Hz wireless transmission has a 1ms response time, whereas 500Hz has 2ms. Choose the appropriate report rate based on your gaming needs.

Question How many wireless devices can be used in the same environment?

Answer We recommend using 10 units or fewer. For more than 10 units, maintain a distance of 1.5m to 3m between them.

Q&A

Question Will other wireless devices at home cause interference with my mouse?

Answer This mouse features advanced anti-interference technology:
1. Excellent interference resistance, transmitting four times within 1ms (conventional products transmit once).
2. Intelligent frequency hopping to dynamically adjust power (0-6dB), reducing the need for hopping (conventional products have fixed power).
3. The USB anti-interference extension cable creates a clean wireless environment (reducing metal and obstacle attenuation).

TECH SPEC

Sensor:	PAW3395 Gaming Optical Engine	
Wireless Transmission:	1ms	
Operation Range:	10 m	
Default Resolution:	400-800-1,000-1,200-1,600-2,000 CPI	
Adjustable by Software:	50-26,000 CPI	
Frame Speed:	Self-Adjusting	
Adjustable by Software:	Self-Adjusting	
Acceleration:	50 G	
Tracking Speed:	650 IPS	
Report Rate:	1000Hz Adjustable	
Battery:	300 mAh Lithium Battery	
Charging Time:	≤ 1.5 Hours	
Playtime:	≤ 80 Hours	
Micro-Switch:	Over 30 Million Clicks (Left / Right Button)	
Wheel:	Over 800,000 Scrolls	
USB Type-C Soft Braided Cable:	180 cm	
USB Type-C PVC Cable:	180 cm	
Size:	125 x 63 x 40 mm	
Weight:	70 g (w/o cable)	

WARNING STATEMENT

The following actions may cause damage to the product:

- 1. Disassembling, bumping, crushing, or throwing into the fire can cause irreparable damage due to lithium battery leakage.
- 2. Follow exposing to strong sunlight.
- 3. Avoid local laws for battery disposal; recycle if possible. Improper disposal may cause fire or explosion.
- 4. Avoid charging in environments below 0°C.
- 5. Do not remove or replace the battery.
- 6. Do not use chargers with outputs from 6V to 24V. Use a 5V charger to avoid damage.



www.Bloody.com

Scan for E-Manual