

# User Manual

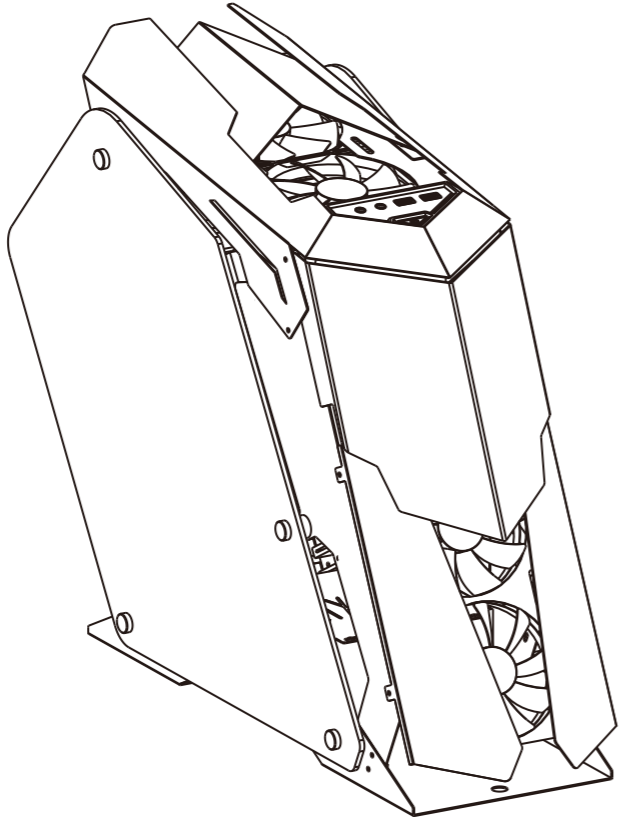

WEEE DIRECTIVE & PRODUCT DISPOSAL  
 AT THE END OF ITS SERVICEABLE LIFE, THIS PRODUCT SHOULD BE TREATED AS HOUSEHOLD OR GENERAL WASTE. IT SHOULD BE HANDED OVER TO THE APPLICABLE COLLECTION POINT FOR THE RECYCLING OF ELECTRICAL AND ELECTRONICS EQUIPMENT, OR RETURNED TO THE SUPPLIER FOR DISPOSAL.

## Specification:

- Size: 625\*225\*525mm(L\*W\*H)
- Motherboard: ITX, Micro ATX, ATX
- Hardware Space: 3.5"HDD\*1+2.5"SSD\*1 or 2.5"SSD\*3
- Expansion Slots: 7
- Power Supply: ATX power supply installed at the bottom
- Cooling Support (all optional):
  - Front Panel: 120mm Fan × 3 (Liquid cooling radiator is not supported)
  - Rear Panel: 120mm Fan × 2 (Liquid cooling radiator is not supported)
  - Top Panel: 120mm Fan × 2 (240mm Liquid cooling radiator is supported)

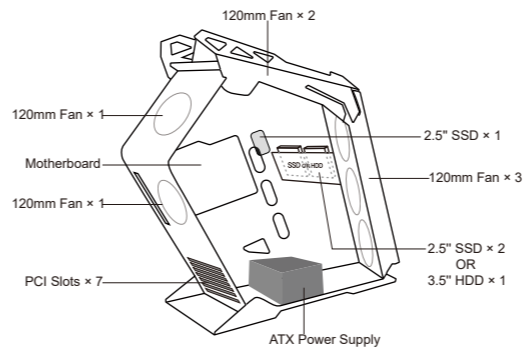

## Description:

- Left and right sides panel are made of tempered glass. Right side provide more space for cable management.
- I/O ports on the top panel: USB2.0 × 1, USB3.0 × 1, Headphone × 1, Microphone × 1

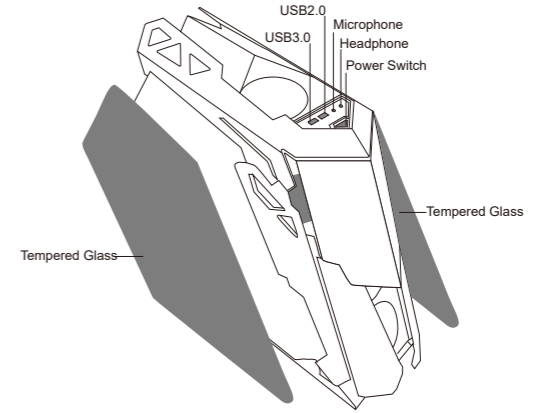

## Left & Right Panels Removal:

- Left Panel: Take out the four plastic thumb screws, and pull the left panel backward to remove it.
- Right Panel: Take out the four plastic thumb screws, and pull the right panel backward to remove it.

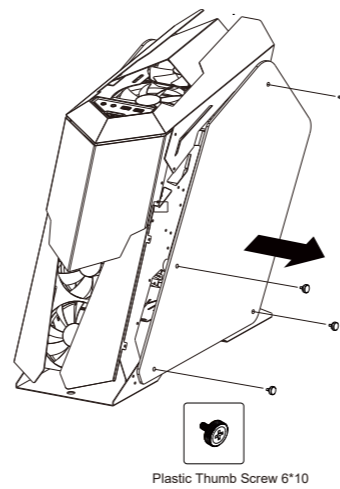

## Hard Drive Installation:

- Match the HDD / SSD with the hole locations of the panel, and Place your 2.5" SSD / 3.5" HDD drive in and secure with screws.

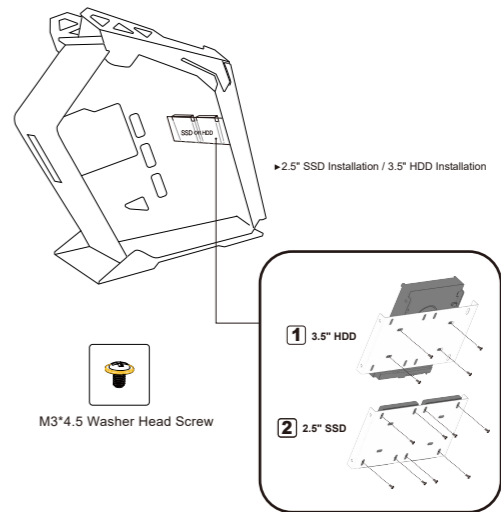

## Power Supply Installation:

Place the PSU into the chassis from the right side as shown in the picture. Use four 6\*6 hexagon head screws to secure the PSU to the rear panel.

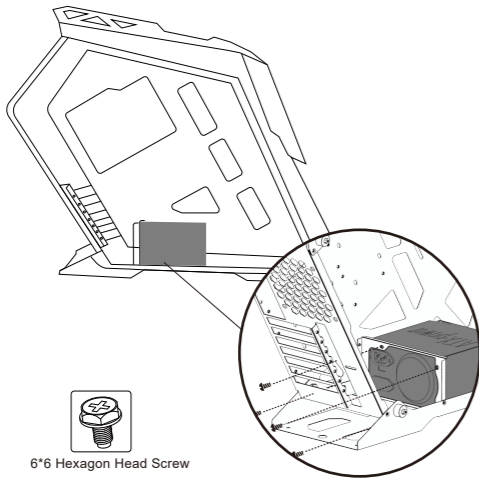

## Motherboard Installation:

Take a corresponding number of M4\*10\*6 Brass Standoffs out of the component bag and install them in the tray. Match the motherboard with the I/O interface locations and place it on the standoffs. Take a corresponding number of M3\*4.5 Washer Head Screws out of the component bag to secure the motherboard.

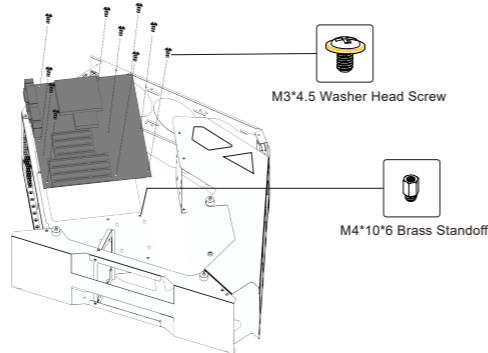

## Expansion Card Installation:

- Apply pressure and bend the add-on card cover until it comes free. Slide the PCI/PCI-E card into position and secure with provided 'Add-On Card Screw'.

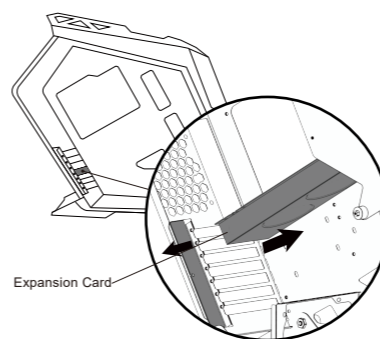

## Front Panel Removal:

- Find the front-panel cut-out. Firmly stabilize the chassis with one hand. Apply a gradual pulling force with your other hand (using the cut-out). Note: Be wary of wires attached to front-panel.

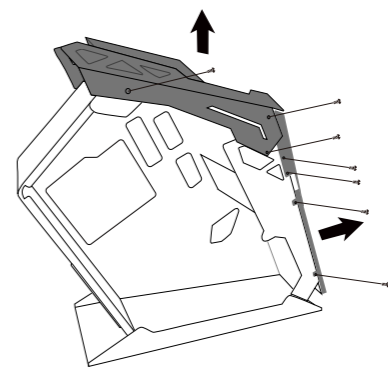

## Fan installation:

- Front Panel: 120mm Fan × 3 (Liquid cooling radiator is not supported)
- Rear Panel: 120mm Fan × 2 (Liquid cooling radiator is not supported)
- Top Panel: 120mm Fan × 2 (240mm Liquid cooling radiator is supported)

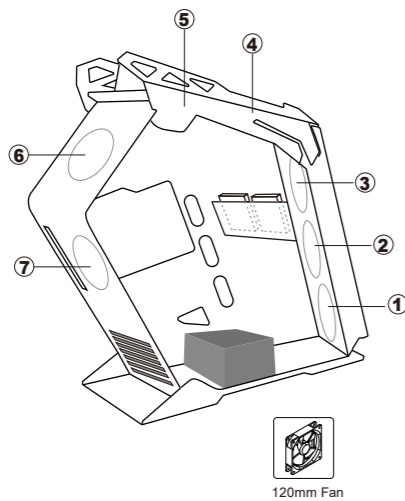

## Component Bag

### 1. Components Description

M3\*4.5 washer head screw to secure the motherboard and the 2.5" SSD

M4\*10\*6 brass standoff to support the motherboard

Cable tie to fasten cables to the motherboard tray

### 2. Explanation of I/O Port Symbols

Power switch, Microphone, Headphone

### 3. Concentrate RGB Animation



5 PCS 120mm RGB fans are pre-installed, no need to buy fans anymore. Each fan is equipped with 7 acrylic blades and RGB LEDs for brilliant customizable lighting. Leaving you with only enjoyable 16.8 million colors light and airflow.

## Cable Connection Guide

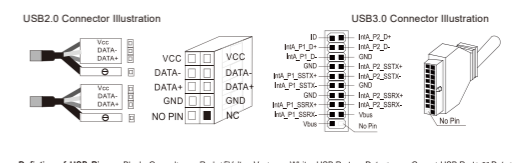
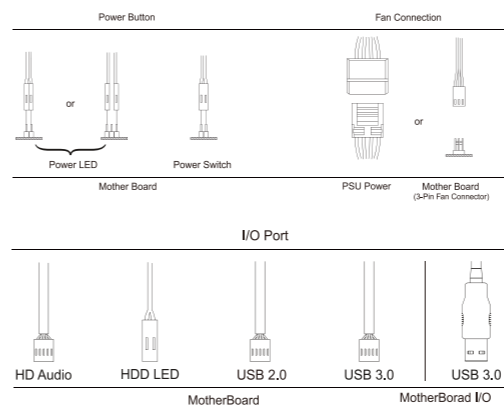

Definition of USB Pins: Black: Ground, Red: +5V or Vcc, White: USB Port or Data-, Green: USB Port or Data+

RESET SW (2-pin RESET)  
 Connect -colored wire to "+" on the MB.  
 H.D.D LED (2-pin IDE\_LED)  
 Connect -colored wire to "+" on the MB.  
 POWER SW (2-pin PWR SW)  
 connect -colored wire to "+" on the MB.  
 POWER LED (3-pin PLED)  
 connect green-colored wire to "+" on the MB.

Note: It's preferable to check the Mother Board manual. This manual is just for reference.