

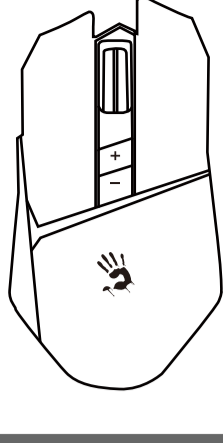

# QUICK START GUIDE



# R36 Ultra



## WHAT'S IN THE BOX



Wireless Mouse



Nano USB Receiver



Anti-Interference Extension Dock



Teflon Boot



USB Type-C Cable



User Manual

## KNOW YOUR PRODUCT

Scroll Wheel / Scroll Button / Speed Indicator Light

CPI Button\* 1000-1200-1600-2000-3200

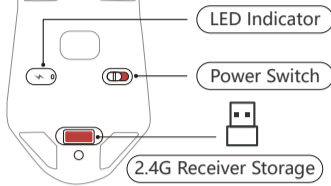
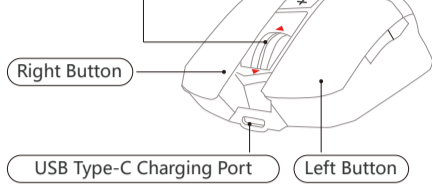

\* Adjustable by Software: 100~12,000 CPI

## CONNECTING 2.4G DEVICE

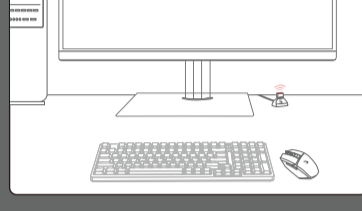

① Connect to the Desktop Computer  
Connect the extension dock to the host computer, and plug the nano receiver into the extension cord. Place it in front of the mouse, with no obstructions between it.

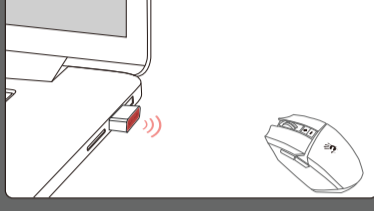

② Connect to the Laptop Computer  
Connect the nano receiver to the laptop computer with no obstructions between the mouse.

## CONNECTING USB WIRED

The mouse switches from wireless mode to wired mode when the USB Type-C cable is plugged in.

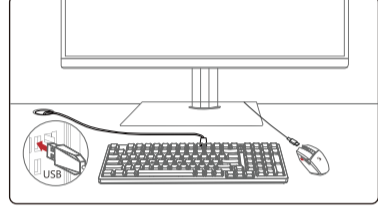

Connect to the Desktop Computer

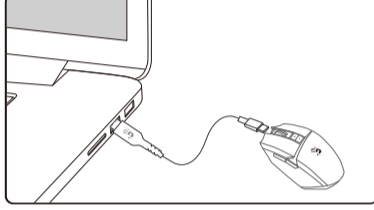

Connect to the Laptop Computer

## WIRELESS M-ESPORT EDITOR

Provide the mouse with simple combination settings and programming functions. Players can optimize the most suitable game configuration by buttons, sensitivity, and combination macros, then save it to the mouse on-board memory.



Download Link: <http://www.bloody.com/en/download.php>

## CHARGING & INDICATOR

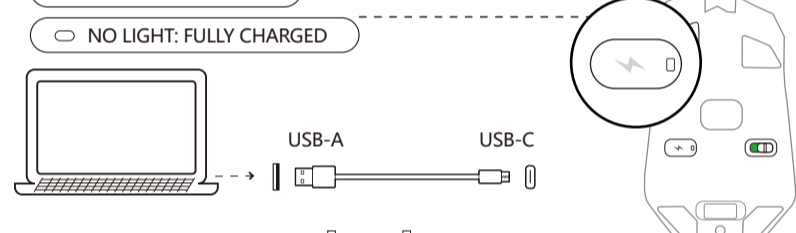

## INDICATOR

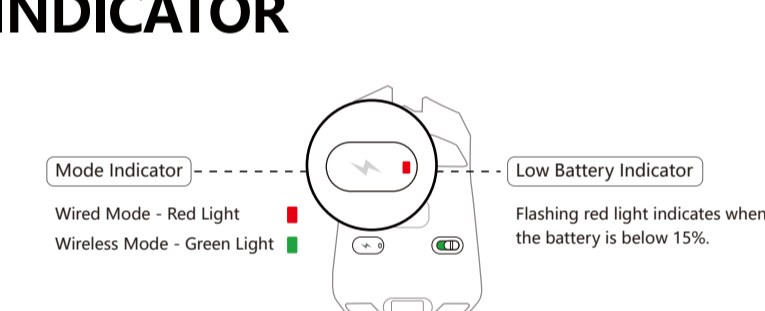

## Q & A

**Question** How to switch wireless or wired mode?

**Answer** Plug in the USB cable to connect with wired mode.  
Plug in the 2.4G nano receiver to switch to wireless mode.

**Question** When connected with 2.4G wireless mode, the mouse occasionally experiences intermittent lag. How can I solve this problem?

**Answer** Please follow the steps below to check.  
1. Whether the receiver is inserted in the USB anti-interference extension cable seat.  
2. Whether the wireless environment is used within 30~100cm, and no obstacles and metal objects cover.  
3. Whether there is a strong power wireless router or other wireless transmitter interference source within 1 meter around.

## Q & A

**Question** Wireless 1000Hz transmission is smooth and like wired, can I achieve the same effect with 500Hz?

**Answer** The wireless transmission of 1000Hz is 1ms, while for 500Hz is 2ms.  
The players can select the proper report rate during the game experience.

**Question** Is there a maximum number of wireless products that can be used in the same environment?

**Answer** We recommend 10 units or less. (For more than 10 units, it is recommended to be 1.5m~3m apart)

## Q & A

**Question** There are some wireless devices at my home. Will this cause signal interference when I use the mouse via wireless mode?

**Answer** This wireless mouse has powerful wireless anti-interference technology as follows:  
1. Excellent anti-interference, transmit four times in 1 ms. (Conventional wireless products transmit only one signal)  
2. Intelligent frequency hopping mechanism, the same frequency interference can be dynamically adjusted to transmit power 0 ~ 6db, reducing the need for wireless frequency hopping. (Conventional wireless products are fixed transmission power)  
3. With USB anti-interference extension cable can create a clean wireless environment. (Reduce the attenuation of metal and obstacles on the wireless performance)

## TECH SPEC

Sensor: PAW3313 Gaming Optical Engine  
Wireless Transmission: 1ms  
Operation Range: 10 m  
Default Resolution: 1000-1200-1600-2000-3200 CPI  
Adjustable by Software: 100~12,000 CPI  
Frame Speed: Self-Adjusting  
Acceleration: 35 G  
Tracking Speed: 300 IPS  
Report Rate: 1000Hz Adjustable  
Wireless Transmission: 1 ms  
Micro-Switch: Over 20 Million Clicks (Left / Right Button)  
Wheel: Over 800,000 Scrolls  
USB Type-C Charging Cable Length: 180 cm  
USB Extension Dock Cable Length: 120 cm  
Size: 130 x 70 x 39 mm  
Weight: 89 g (w/o cable), 126 g (w/ cable)  
Color: Stone Black

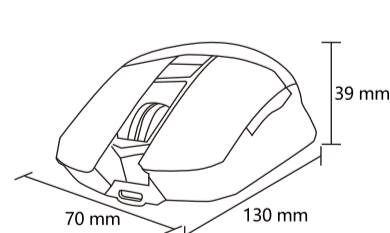

## WARNING STATEMENT

The following actions may/will cause damages to the product.

- To disassemble, bump, crush, or throwing into fire, you may cause irrefutable damages in event of the lithium battery leakage.
- Do not expose under the strong sunlight.
- Please obey all local laws when discarding the batteries, if possible please recycle it. Do not dispose it as household garbage, it may cause a fire or an explosion.
- Please try to avoid charging in the environment below 0°C.
- Do not remove or replace the battery.
- Forbidden to use 6V to 24V charger, otherwise the product will be burned. Recommended to use a 5V charger for charging.



[www.bloody.com](http://www.bloody.com)



Scan for E-Manual