

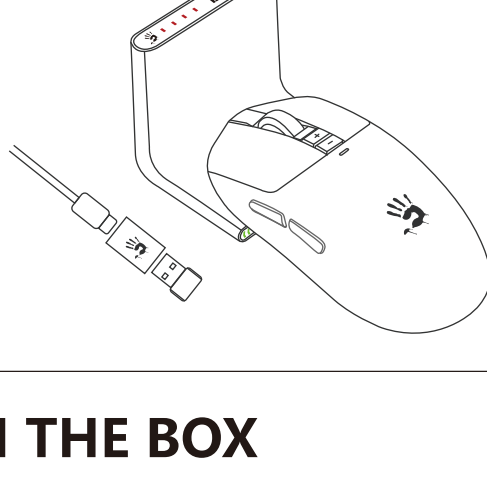

R72 Ultra Duo

QUICK START GUIDE



WHAT'S IN THE BOX

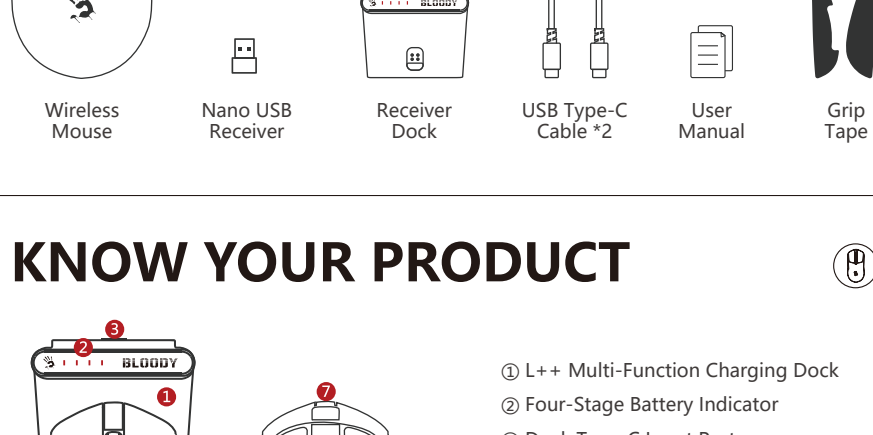

KNOW YOUR PRODUCT

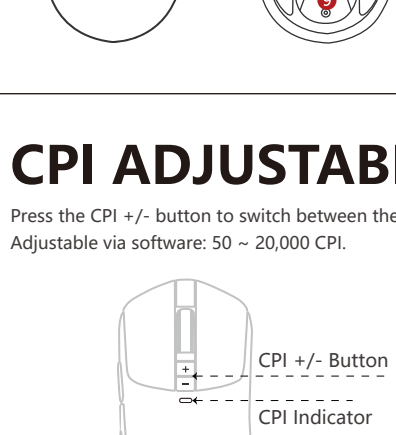

- ① L++ Multi-Function Charging Dock
- ② Four-Stage Battery Indicator
- ③ Dock Type-C Input Port
- ④ CPI +/- Adjustable
- ⑤ Function Indicator
- ⑥ Snap-On Magnetic Charging
- ⑦ Mouse Type-C Input Port
- ⑧ Dual 2.4G Receiver Switch
- ⑨ 2.4G Receiver Storage

CPI ADJUSTABLE

Press the CPI +/- button to switch between the default resolutions: 400, 800, 1000, 1200, 1600, 2000 CPI. Adjustable via software: 50 ~ 20,000 CPI.

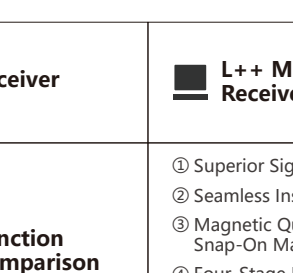

Indicator	Default Resolution
	400 CPI
	800 CPI
	1000 CPI
	1200 CPI
	1600 CPI
	2000 CPI

*If the CPI button is not clicked for 15s, the indicator will turn off automatically.

DUAL 2.4G RECEIVER

Press the CPI +/- button to switch between the default resolutions: 400, 800, 1000, 1200, 1600, 2000 CPI. Adjustable via software: 50 ~ 20,000 CPI.

Receiver	L++ Multi-Function Receiver Dock	USB Nano Receiver
Function Comparison	<ul style="list-style-type: none"> ① Superior Signal Stability ② Seamless Instant Pairing ③ Magnetic Quick-Charge Snap-On Magnetic Charging ④ Four-Stage Battery Indicator ⑤ 1000Hz Report Rate ⑥ Desktop Use 	<ul style="list-style-type: none"> ① Superior Signal Stability ② 1000Hz Report Rate ③ Travel Portable

DUAL 2.4G RECEIVER SWITCH

If both receivers are connected, you can choose the active one using the switch on the bottom of the mouse.

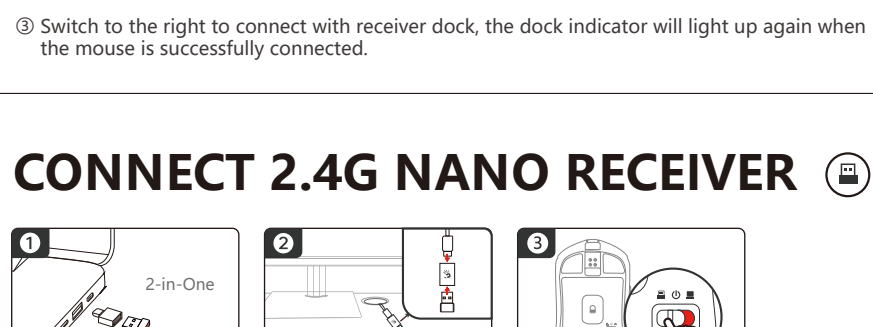

- ① Press to pop up the lid.
- ② Take out the Nano Receiver and put the lid back.

CONNECT RECEIVER DOCK

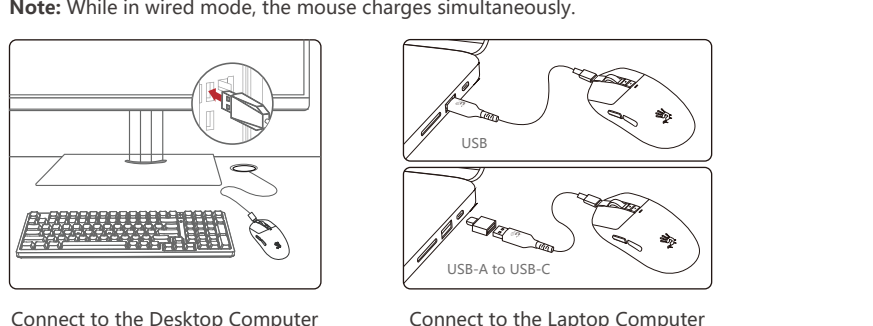

- ① Connect the Type-C cable to the receiver dock and computer, the dock indicator will light up then light off in 15s if not in use.
- ② Remove the transparent film from the bottom of the dock so that the dock fits securely on the desk.
- ③ Switch to the right to connect with receiver dock, the dock indicator will light up again when the mouse is successfully connected.

CONNECT 2.4G NANO RECEIVER

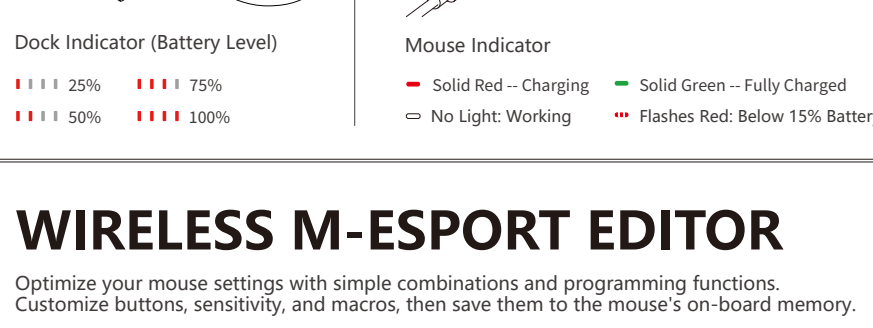

- ① **Laptop Use:** Plug the receiver into the laptop's USB port or use the Type-C adaptor to connect the receiver to the laptop's Type-C port.
- ② **Desktop Use:** Use the adaptor to connect the nano receiver to the USB Type-C cable, then plug it into the desktop for wireless signal anti-interference.
- ③ Switch to the left to connect with nano receiver.

CONNECTING USB WIRED

The mouse will switch from wireless to wired mode when the USB Type-C cable is connected. Note: While in wired mode, the mouse charges simultaneously.



- Connect to the Desktop Computer
- Connect to the Laptop Computer

CHARGING & INDICATOR

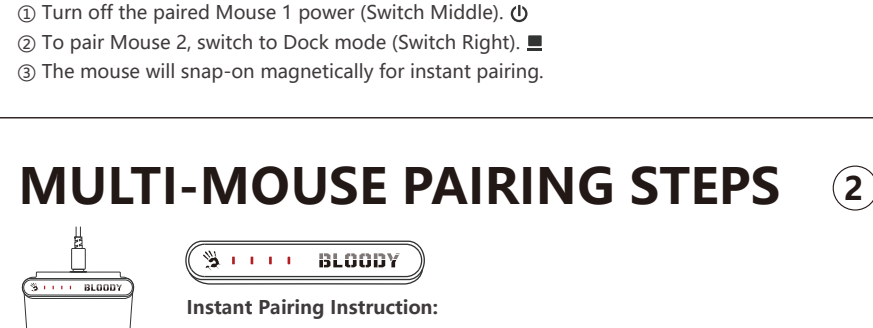

- Dock Charging**
 - Dock Indicator (Battery Level)
 - 25% (4 bars)
 - 50% (6 bars)
 - 75% (8 bars)
 - 100% (10 bars)
- Type-C Charging**
 - Mouse Indicator
 - Solid Red -- Charging
 - No Light: Working
 - Solid Green -- Fully Charged
 - Flashes Red: Below 15% Battery

WIRELESS M-ESPORT EDITOR

Optimize your mouse settings with simple combinations and programming functions. Customize buttons, sensitivity, and macros, then save them to the mouse's on-board memory.

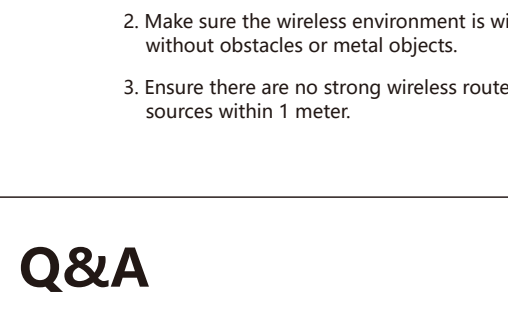

Download Link: <http://www.bloody.com/en/download.php>

FIRMWARE UPDATE OPERATION

Ensure the USB connection is not interrupted during the update process.

- ① Plug both the mouse and dongle into the USB port.
- ② Confirm that the mouse and dual receivers are online simultaneously.
- ③ When prompted to upgrade the firmware, click the Upgrade button to complete the process.

Wireless Re-pairing Operation:

- ③ Plug in the mouse and the dual wireless receiver, then click the Pair Code button to re-pair.

Note: Only newly purchased USB Nano receivers need to be re-paired.

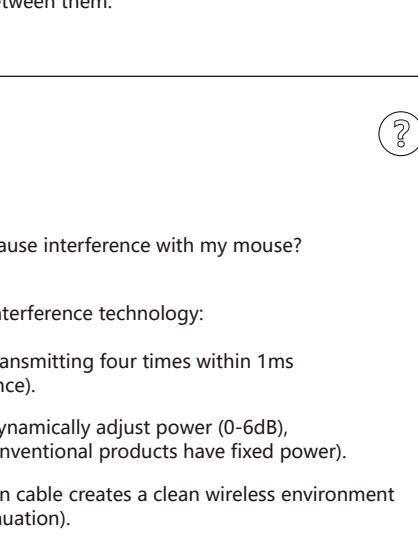

MULTI-MOUSE PAIRING STEPS 1

When using the L++ multi-function dock, it can pair with multiple wireless mice that support dual-connected wireless systems. Here's how to perform random pairing.

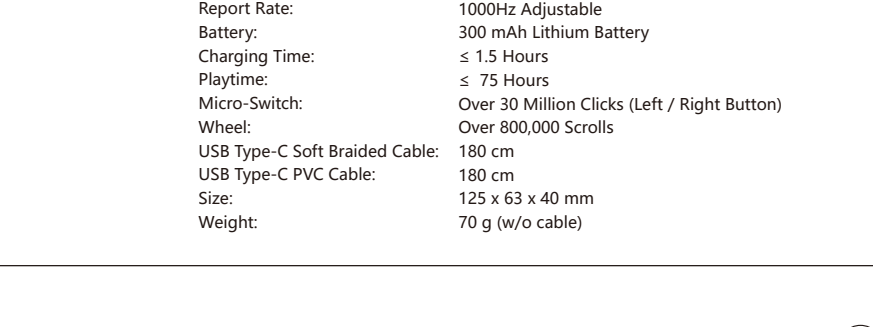

- ① Turn Mouse 1, Mouse 2, Up to 10pcs
- ② To pair Mouse 2, switch to Dock mode (Switch Right).
- ③ The mouse will snap-on magnetically for instant pairing.

MULTI-MOUSE PAIRING STEPS 2

Instant Pairing Instruction:



- ③ Pairing completes in 1s. After pairing, the dock displays the current battery level of the mouse.
- * Note: If the charging dock lights keep flashing during pairing, check whether the mouse is correctly positioned on the dock.

Q&A

Question When connected in 2.4G wireless mode, the mouse sometimes lags. How can I fix this?

- Answer** Check the following:
1. Ensure the USB Nano receiver is connected to the adaptor and the USB Type-C cable is properly plugged in.
 2. Make sure the wireless environment is within 30-100 cm, without obstacles or metal objects.
 3. Ensure there are no strong wireless routers or other interference sources within 1 meter.

Q&A

Question Wireless 1000Hz transmission is smooth like wired. Can I achieve the same with 500Hz?

- Answer** 1000Hz wireless transmission has a 1ms response time, whereas 500Hz has 2ms. Choose the appropriate report rate based on your gaming needs.

Question How many wireless devices can be used in the same environment?

- Answer** We recommend using 10 units or fewer. For more than 10 units, maintain a distance of 1.5m to 3m between them.

Q&A

Question Will other wireless devices at home cause interference with my mouse?

- Answer** This mouse features advanced anti-interference technology:
1. Excellent interference resistance, transmitting four times within 1ms (conventional products transmit once).
 2. Intelligent frequency hopping to dynamically adjust power (0-6dB), reducing the need for hopping (conventional products have fixed power).
 3. The USB anti-interference extension cable creates a clean wireless environment (reducing metal and obstacle attenuation).

TECH SPEC

Sensor:	Alpha 20K Engineered Engine
Wireless Transmission:	1ms
Operation Range:	10 m
Default Resolution:	400-800-1,000-1,200-1,600-2,000 CPI
Adjustable by Software:	50-20,000 CPI
Frame Speed:	Self-Adjusting
Adjustable by Software:	Self-Adjusting
Acceleration:	40 G
Tracking Speed:	350 IPS
Report Rate:	1000Hz Adjustable
Battery:	300 mAh Lithium Battery
Charging Time:	≤ 1.5 Hours
Playtime:	≤ 75 Hours
Micro-Switch:	Over 30 Million Clicks (Left / Right Button)
Wheel:	Over 800,000 Scrolls
USB Type-C Soft Braided Cable:	180 cm
USB Type-C PVC Cable:	180 cm
Size:	125 x 63 x 40 mm
Weight:	70 g (w/o cable)

WARNING STATEMENT

The following actions may cause damage to the product:

1. Disassembling, bumping, crushing, or throwing into the fire can cause irreparable damage due to lithium battery leakage.
2. Avoid exposing to strong sunlight.
3. Follow local laws for battery disposal; recycle if possible. Improper disposal may cause fire or explosion.
4. Avoid charging in environments below 0°C.
5. Do not remove or replace the battery.
6. Do not use chargers with outputs from 6V to 24V. Use a 5V charger to avoid damage.

www.Bloody.com

Scan for E-Manual