

# User Manual

BLMS RGB GAMING KEYBOARD

Compatible with: **S310N, S520N, S525N**



www.Bloody.com



Scan for E-Manual

## COMBINATION FN KEYS

### Default 10 Preset Lighting Effects

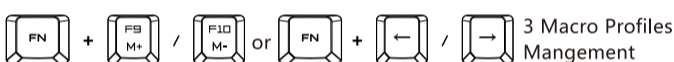
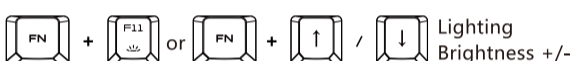
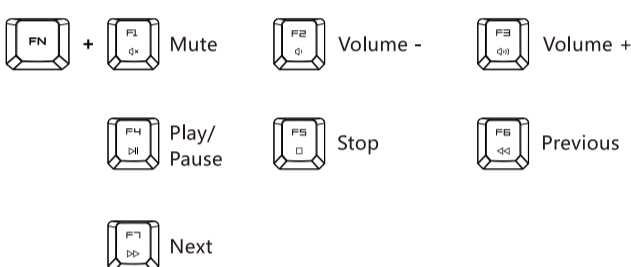

## SWAP SWITCH STEP

### How to Replace Switches?

The keyboard switches are hot-swappable and compatible with most the 3-pin & 5-pin mechanical switches on the market. Extra switches are not included in the package.

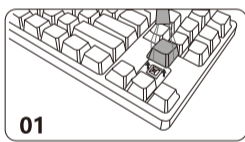

01 Remove the keycaps with the keycap puller.

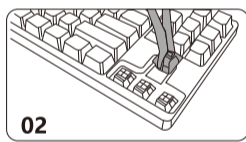

02 Remove the switches with the switch puller.

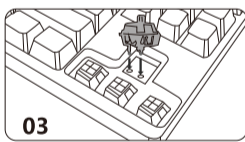

03 Line up the switch pins with the PCB socket.

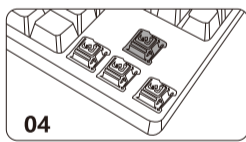

04 Place the switch on the PCB and integrate it closely.

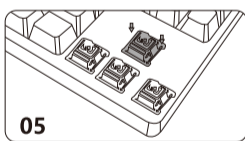

05 Gently press the switch into place.

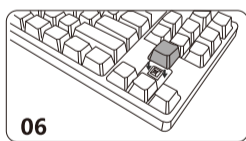

06 Put the keycaps back on to the keyboard and test it.

## INSTALLATION

### Connection

Plug the USB cable into the computer USB port.

(Note: Using a USB hub or extension cable for connection is not recommended.)

### Software Download

For the best product performance, please download and install the KeyDominator Gaming Software from <https://bloody.com/en/download.php>.